

Universal construction panel

**LUX ELEMENTS®-ELEMENT-EL ...**

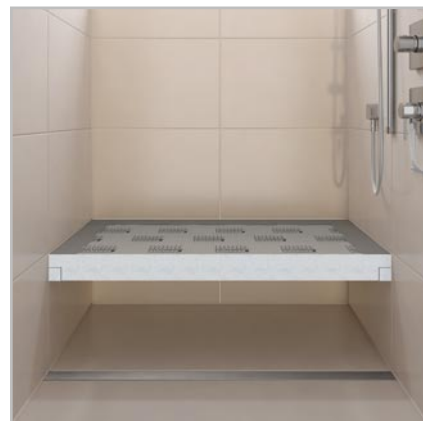

**[ EN ] – Instructions for assembly**

**Floating bench seat –**

without base frame,  
for installation into a niche

# LUX ELEMENTS®-ELEMENT-EL ...

All ELEMENT-... construction panels must be stored lying down straight in a dry place. If an ELEMENT construction panel should be slightly warped due to improper storage or other reasons, they can usually be straightened by light bending and pressing. Allow the ELEMENT-... construction panels to adapt to environmental conditions such as temperature and humidity before processing.

Cuts and notches are made quickly and easily with the jig saw or a cutter knife.

## TOOLS/MATERIALS REQUIRED

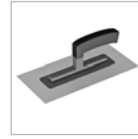

LUX ELEMENTS®-COL-...  
LUX ELEMENTS®-DRY-ASK

**PLEASE NOTE:**  
Wear protective gloves/clothing,  
eye and face protection

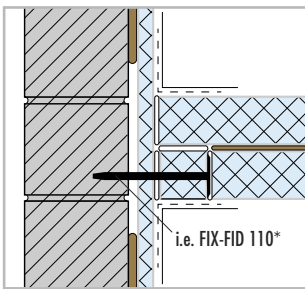

The shorter ELEMENT-EL Baby 50 construction panels are also suitable for this application.

It is possible to produce a floating bench seat without base frame with a maximum length of up to 1,300 mm. The basic requirement is the attachment to loadbearing walls (niche installation) on three sides.

**Please note:** All contact surfaces must be almost completely adhered.

\* Additional mechanical anchoring with suitable FIX-... fastening sets may be possible and/or necessary depending on the type of walls.

### Support strips

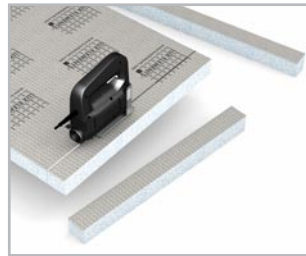

Cut three support strips (1x long = niche width x 50 mm x 50 mm, 2x short = seat depth -50 mm x 50 mm x 50 mm) from ELEMENT-EL (Baby) 50.

### Seat elements



Cut two elements for the seat (top element = niche width x seat depth x 50 mm, bottom element = niche width -100 mm x seat depth -50 mm x 50 mm) from ELEMENT-EL (Baby) 50.



Adhere top and bottom seat elements together using COL-AK (alternative: COL-MK) so that the front edges are flush with each other. Allow adhesive to set.



Mark the seat height (take into consideration thickness of the surface) and top edges of the support strips (= seat height - thickness of the surface -50 mm) on the three surrounding walls of the niche.



Apply COL-MK (alternative: COL-AK) to the support strips. We recommend to apply the mounting adhesive in a serpentine pattern.



Adhere the support strips in the correct position to the surrounding walls.



Adhere seat element using COL-MK (alternative: COL-AK) to the supports and the walls. Check that the seat is horizontal!



Reinforce transitions, top and bottom, with glass fibre reinforcement strip ARM-250 SK ...



... and level out with COL-AK fixing adhesive.



Waterproof the direct wet area additionally with DRY-DB... sealing tape components and DRY-ASK sealing filler.



installation videos



material properties



mobile website

We recommend ... a tile size of  $\geq 50 \times 50$  mm. A total pressure load of  $0.1 \text{ N/mm}^2$  must not be exceeded. When using for higher loads such as transport traffic, rack systems etc., please contact the LUX ELEMENTS technical department. Also suitable for heating systems due to continuous temperature resistance up to  $+75^\circ \text{C}$

For further information ... please refer to our documents. Data sheets, test certificates and processing instructions can be downloaded from [www.luxelements.com](http://www.luxelements.com)

We reserve the right to make technical changes · EN-03/2020